

SLAB DETAIL FOR HEATED STRUCTURE

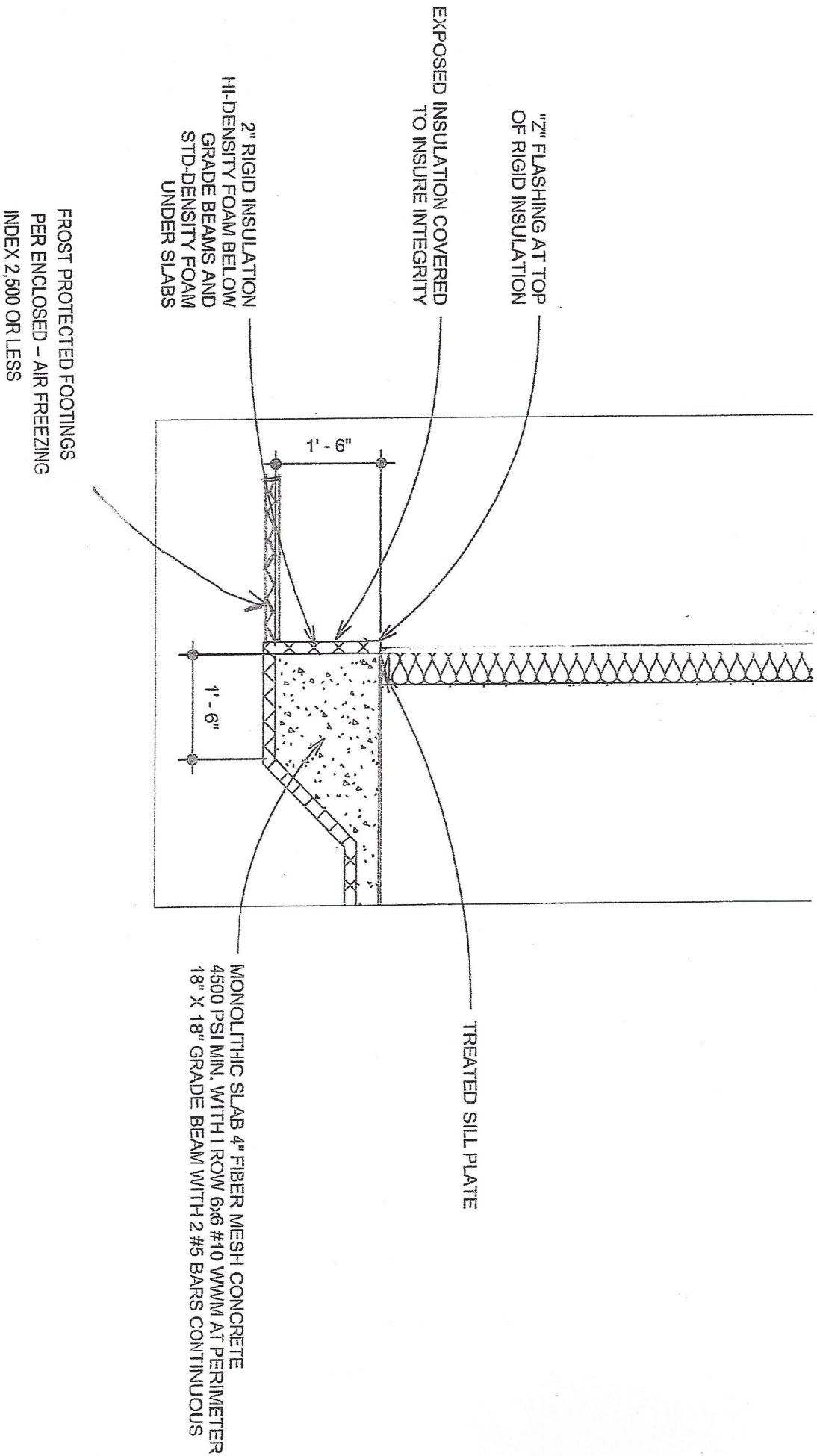

Unofficial Text (See Printed Volume). Current through date and Register shown on Title Page.

Heated Building Design

Minimum Insulation Requirements for Frost-Protected Footings in Heated Buildings¹ (Simplified Method)

Air Freezing Index (°F days) ² (see map)	Vertical Insulation R-Value ^{3, 4}	Horizontal Insulation R-Value ^{3, 5}		Horizontal Insulation Dimensions per Figure Below (inches)			Minimum Footing Depth (inches)
		Along walls	At corners	A	B	C	
2,000 or less	5.6	NR	NR	NR	NR	NR	14
* 2,500 or less	6.7	1.7	4.9	12	24	40	16
3,000 or less	7.8	6.5	8.6	12	24	40	16
3,500 or less	9.0	8.0	11.2	24	30	60	16

1 Insulation requirements are for protection against frost damage in heated buildings. Greater values may be required to meet energy conservation standards. Interpolation between values is permissible.

2 See AFI Contour Map for Air Freezing Index values.

3 Insulation materials shall provide the stated minimum R-values under long-term exposure to moist, below-ground conditions in freezing climates. The following R-values shall be used to determine insulation thicknesses required for this application: Type II expanded polystyrene – 2.4R per inch; Types IV, V, VI, VII extruded polystyrene – 4.5R per inch; Type IX expanded polystyrene – 3.2R per inch. NR indicates that insulation is not required.

4 Vertical insulation shall be expanded polystyrene insulation or extruded polystyrene insulation.

5 Horizontal insulation shall be extruded polystyrene insulation.

